

No responsibility is taken for measurements scaled off this drawing, unless otherwise stated. Use for reference purposes only.

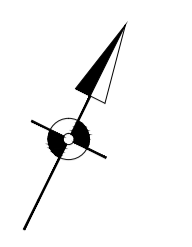

**KEY**

- Pink Hatch - Office Areas
- Blue Hatch - Toilet Facilities
- Brown Hatch - Storage
- Yellow Hatch - Meeting Space/ Green Room
- Red Hatch - Moveable Platform
- Green Hatch - Kitchen Facilities

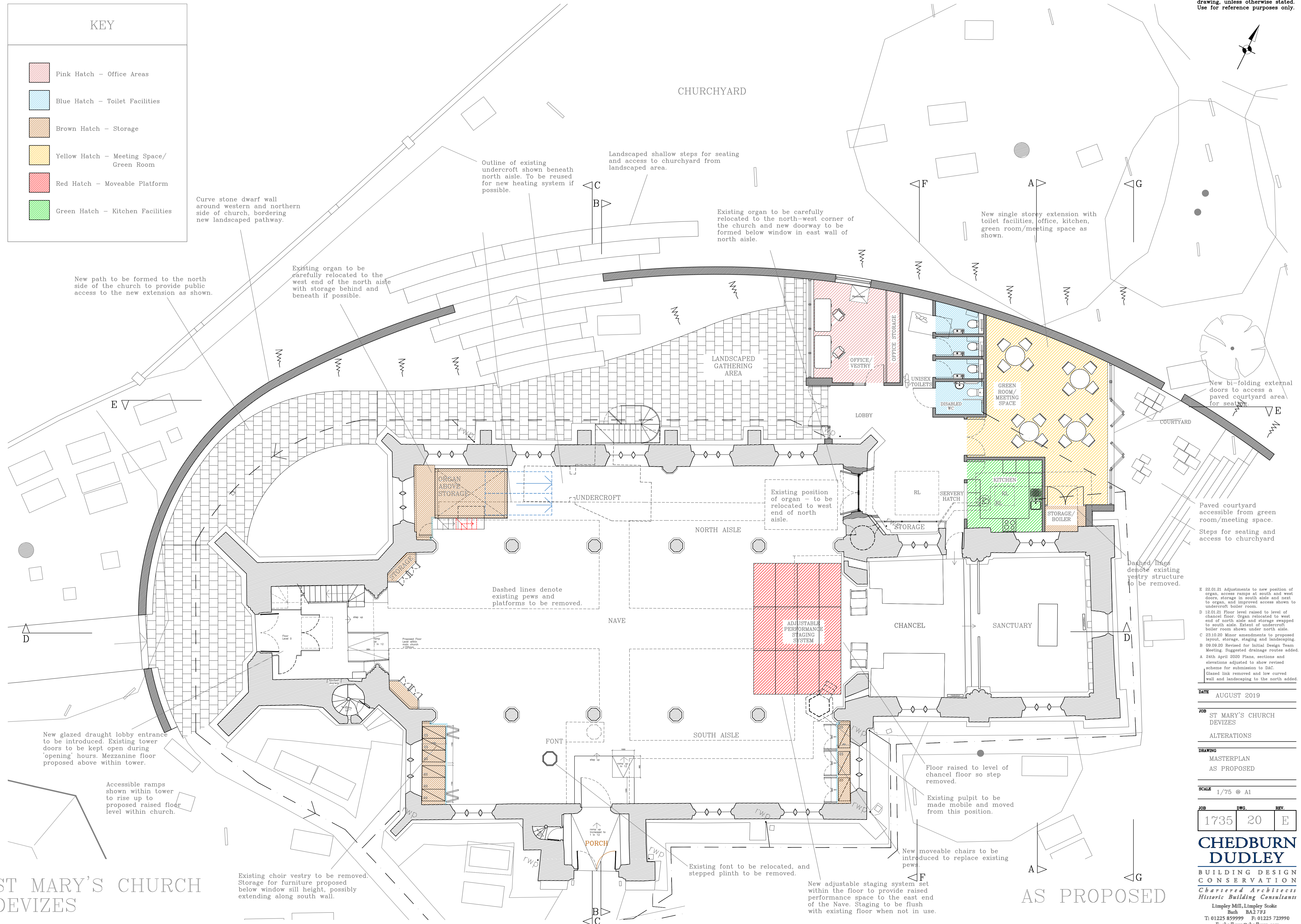

**ST MARY'S CHURCH  
DEVIZES**

**AS PROPOSED**

E 22.01.21 Adjustments to new position of organ, access ramps at south and west doors, storage in south aisle and next to organ, and improved access shown to undercroft boiler room.  
D 12.01.21 Floor level raised to level of chancel floor. Organ relocated to west end of north aisle and storage swapped to south aisle. Extent of undercroft boiler room shown under north aisle.  
C 23.10.20 Minor amendments to proposed layout, storage, staging and landscaping.  
B 09.09.20 Revised for Initial Design Team Meeting. Suggested drainage routes added.  
A 24th April 2020 Plans, sections and elevations adjusted to show revised scheme for submission to DAC.  
Glazed link removed and low curved wall and landscaping to the north added.

DATE	AUGUST 2019		
JOB	ST MARY'S CHURCH DEVIZES		
	ALTERATIONS		
DRAWING	MASTERPLAN AS PROPOSED		
SCALE	1/75 @ A1		
JOB	DWG.	REV.	
1735	20	E	

**CHEDBURN  
DUDLEY**  
BUILDING DESIGN  
CONSERVATION  
Chartered Architects  
Historic Building Consultants  
Limpley Mill, Limpley Stoke  
Bath BA2 7EJ  
T: 01225 859999 F: 01225 723990  
E: chedburn@chedburn.com